

# CUBE2, CUBE4

100% INDIRECT INSTALLATION INSTRUCTIONS

## INDIVIDUAL

- **For pendant mount:** For detailed mounting instructions, please see a separate installation instructions included or check our website [utopialightingus.com](http://utopialightingus.com)

### Aircraft Cable:

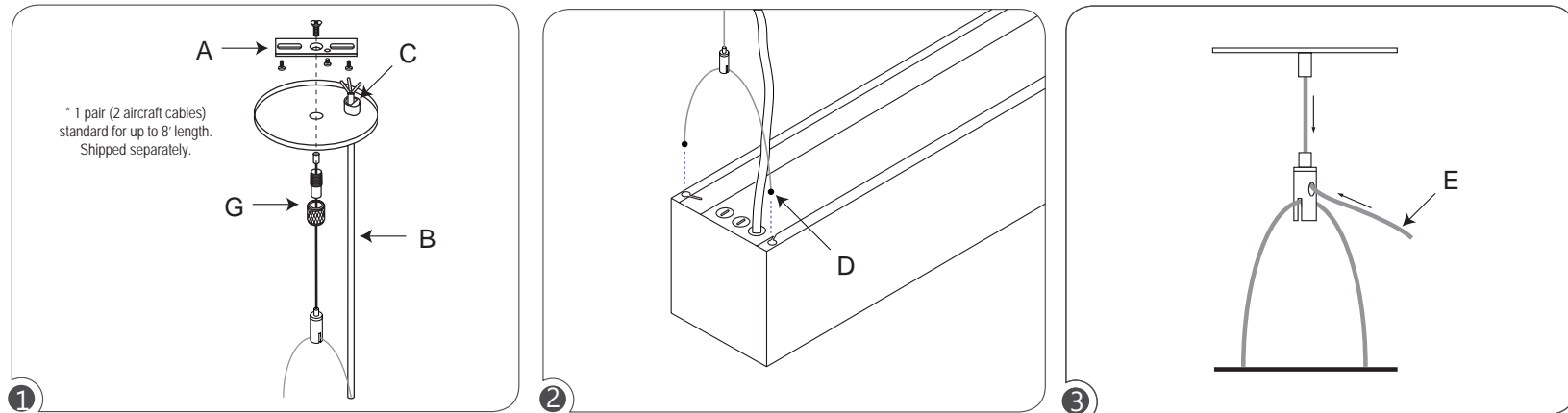

### Stem:

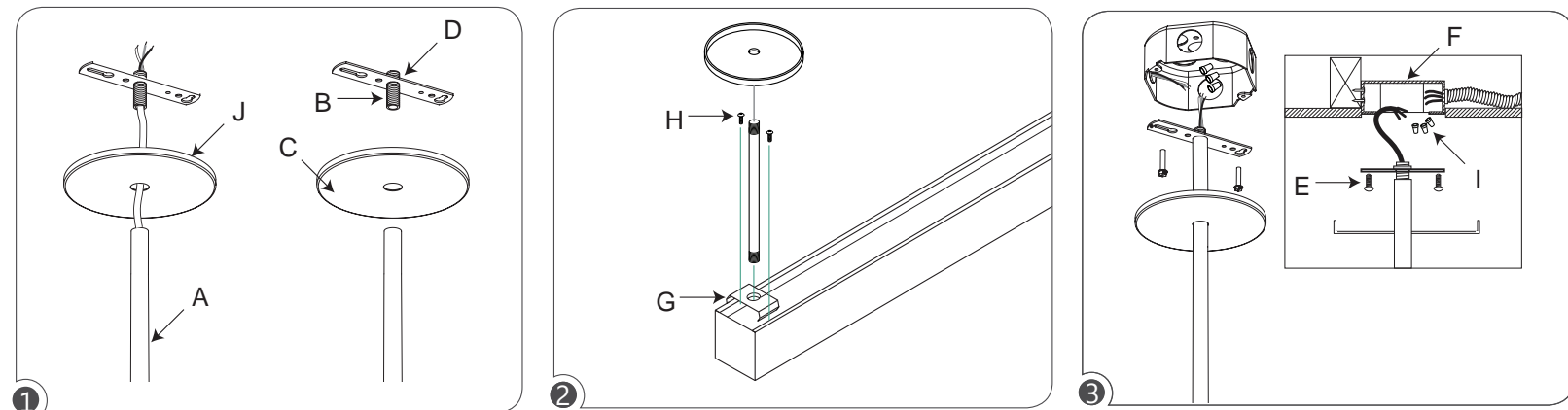

866-471-7711  
utopialighting.com  
info@utopialighting.com

Contractor is responsible for adequately reinforcing ceilings to support luminaire weight. Utopia Lighting accepts no responsibility for inadequately reinforced ceilings. The information contained in this drawing is the sole property of Utopia Lighting. Any reproduction in part or whole is prohibited and warranty voided.

WARNING:



RISK OF FIRE AND ELECTRICAL SHOCK. FIXTURE MUST BE INSTALLED BY A QUALIFIED ELECTRICIAN ONLY IN ACCORDANCE WITH NATIONAL, LOCAL BUILDING AND ELECTRICAL CODES. DISCONNECT POWER AT ELECTRICAL PANEL BEFORE SERVICING.

# CUBE2, CUBE4

100% INDIRECT INSTALLATION INSTRUCTIONS

## INDIVIDUAL

- **For wall mount:** The downlight cover should be installed last after fixing the fixture against the wall using wall mount brackets. For detailed mounting instructions, please see a separate installation instructions included or check our website [utopialightingus.com](http://utopialightingus.com)

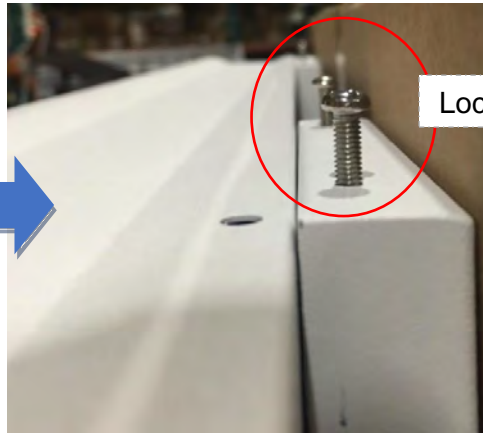

Lock wall mount bracket

Make sure the level of the fixture and wall mount bracket are aligned as shown in this image.



866-471-7711  
[utopialighting.com](http://utopialighting.com)  
[info@utopialighting.com](mailto:info@utopialighting.com)

Contractor is responsible for adequately reinforcing ceilings to support luminaire weight. Utopia Lighting accepts no responsibility for inadequately reinforced ceilings. The information contained in this drawing is the sole property of Utopia Lighting. Any reproduction in part or whole is prohibited and warranty voided.

WARNING:



RISK OF FIRE AND ELECTRICAL SHOCK. FIXTURE MUST BE INSTALLED BY A QUALIFIED ELECTRICIAN ONLY IN ACCORDANCE WITH NATIONAL, LOCAL BUILDING AND ELECTRICAL CODES. DISCONNECT POWER AT ELECTRICAL PANEL BEFORE SERVICING.

# CUBE2, CUBE4

100% INDIRECT INSTALLATION INSTRUCTIONS

## CONTINUOUS ROW

### TOOL(S) NEEDED:

Option 1) Cordless drill and an elbow or L-shape adapter with Philips Insert Bit extension.

Option 2) Flexible Screwdriver with Philips Insert Bit.

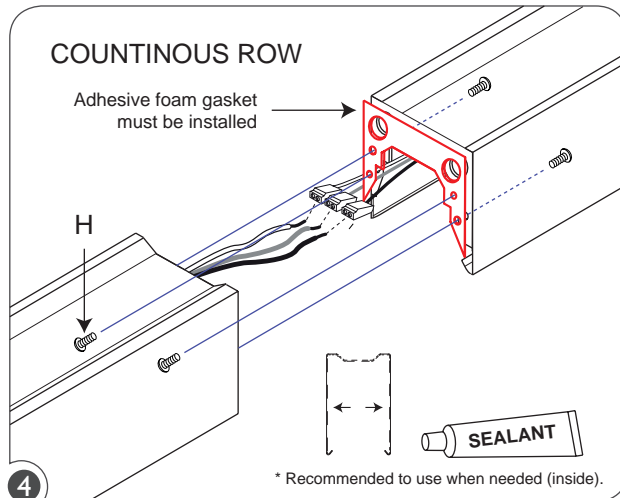
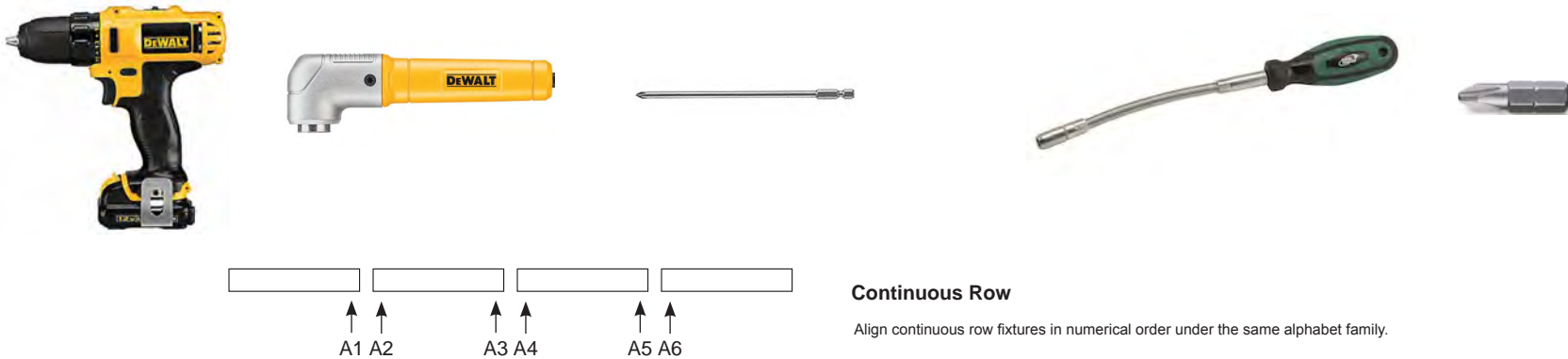

- 1) Make wiring connection from each fixture power supply wires together.
- 2) Align fixtures and screw together with 4 screws(H).



866-471-7711  
utopialighting.com  
info@utopialighting.com

Contractor is responsible for adequately reinforcing ceilings to support luminaire weight. Utopia Lighting accepts no responsibility for inadequately reinforced ceilings. The information contained in this drawing is the sole property of Utopia Lighting. Any reproduction in part or whole is prohibited and warranty voided.

#### WARNING:



RISK OF FIRE AND ELECTRICAL SHOCK. FIXTURE MUST BE INSTALLED BY A QUALIFIED ELECTRICIAN ONLY IN ACCORDANCE WITH NATIONAL, LOCAL BUILDING AND ELECTRICAL CODES. DISCONNECT POWER AT ELECTRICAL PANEL BEFORE SERVICING.

# CUBE2, CUBE4

## 100% INDIRECT INSTALLATION INSTRUCTIONS



Install the downlight cover following the instructions under #1 on the first page to complete installation.

\* Due to the material, it is not recommended to remove the downlight cover once installed.



866-471-7711  
utopialighting.com  
info@utopialighting.com

Contractor is responsible for adequately reinforcing ceilings to support luminaire weight.  
Utopia Lighting accepts no responsibility for inadequately reinforced ceilings.  
The information contained in this drawing is the sole property of Utopia Lighting.  
Any reproduction in part or whole is prohibited and warranty voided.

WARNING:



RISK OF FIRE AND ELECTRICAL SHOCK. FIXTURE MUST BE INSTALLED BY A QUALIFIED ELECTRICIAN ONLY IN ACCORDANCE WITH NATIONAL, LOCAL BUILDING AND ELECTRICAL CODES. DISCONNECT POWER AT ELECTRICAL PANEL BEFORE SERVICING.